

Matrimatic Gold; extra information on stitches and feet.

Changing of feet:

Needle in upper position (1) and also presser foot up (2) with presser foot lever. Push the button at the back (3) and the presser foot will drop off. Put the new foot (4) with pin (A) under the notch of presser foot support (B). Push lever slowly down (5). The pin will fall into the notch.

For some feet, the presser foot support needs to be undone, use screw C.

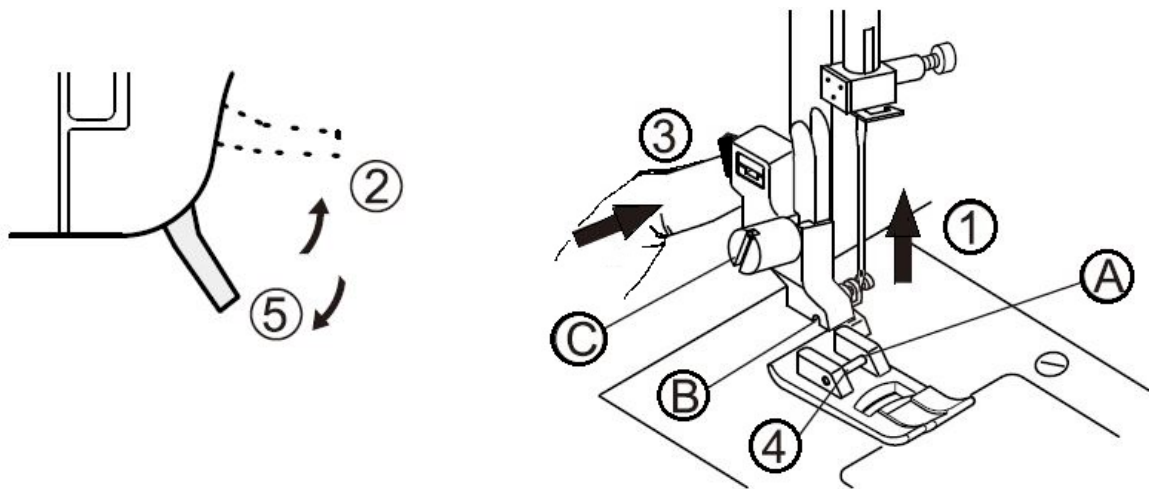

Straight stitch:

Stitch 001 en 002 are normal straight stitches).

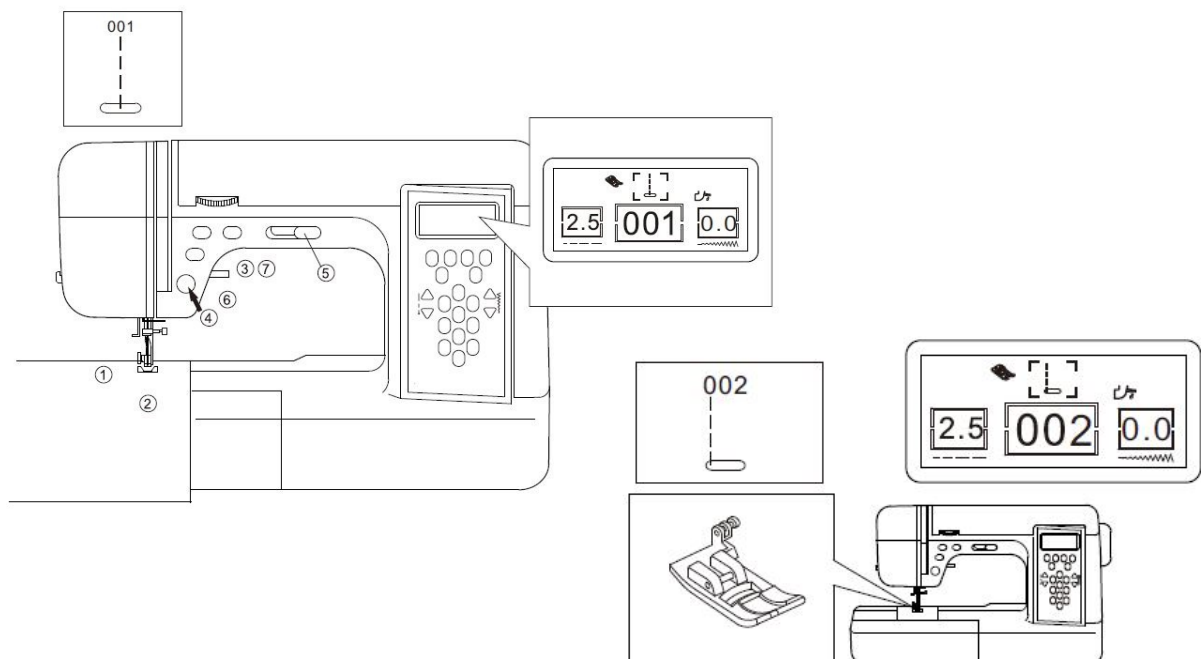

Zigzag stitches:

These stitches are normally used to finish raw edges of fabric, these stitches can also be used to stitch around appliqués.

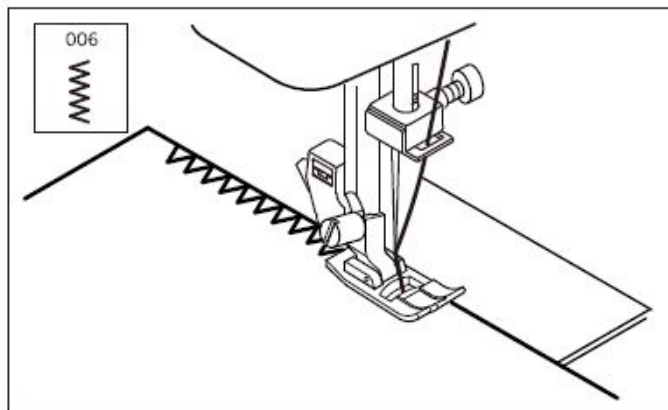
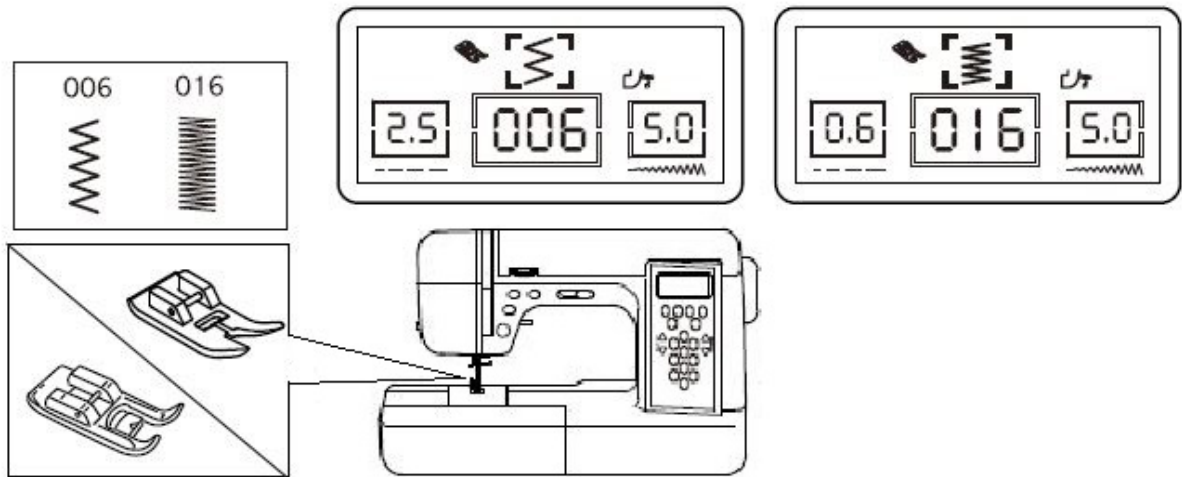

Overlockstitches /stretch stitches:

These stitches are used to sew jersey/stretch fabrics. Using the left foot as shown on the image, the stitch will keep the width as the foot has a kind of finger, the thread will go around this finger while sewing.

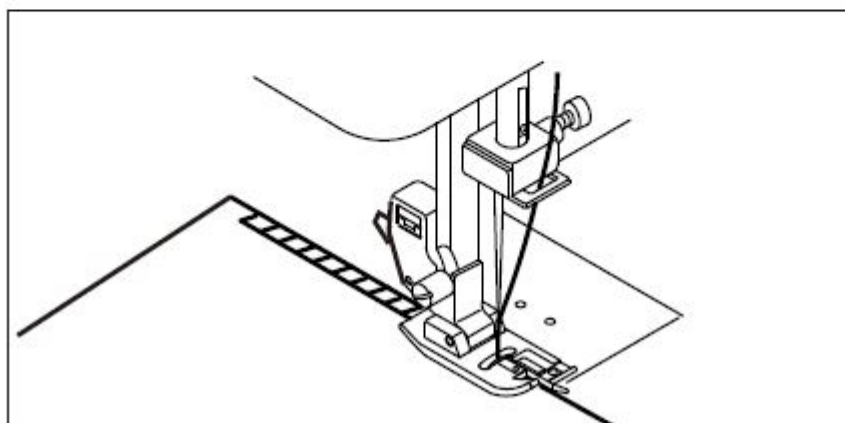
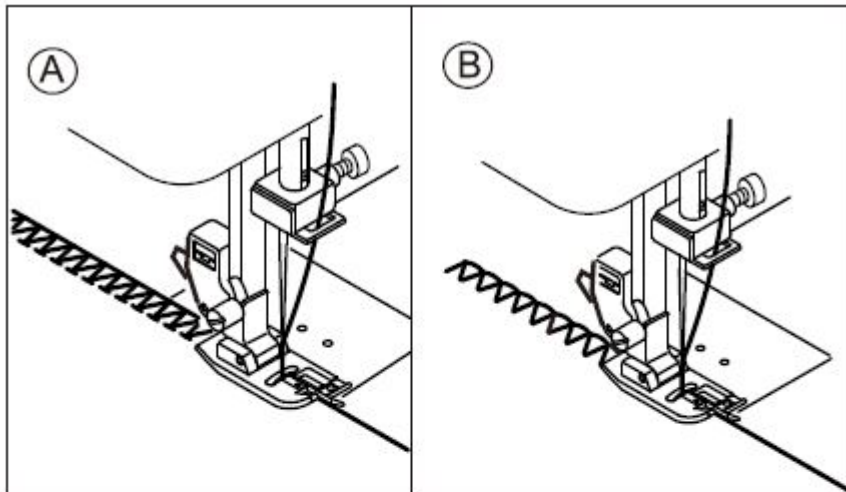
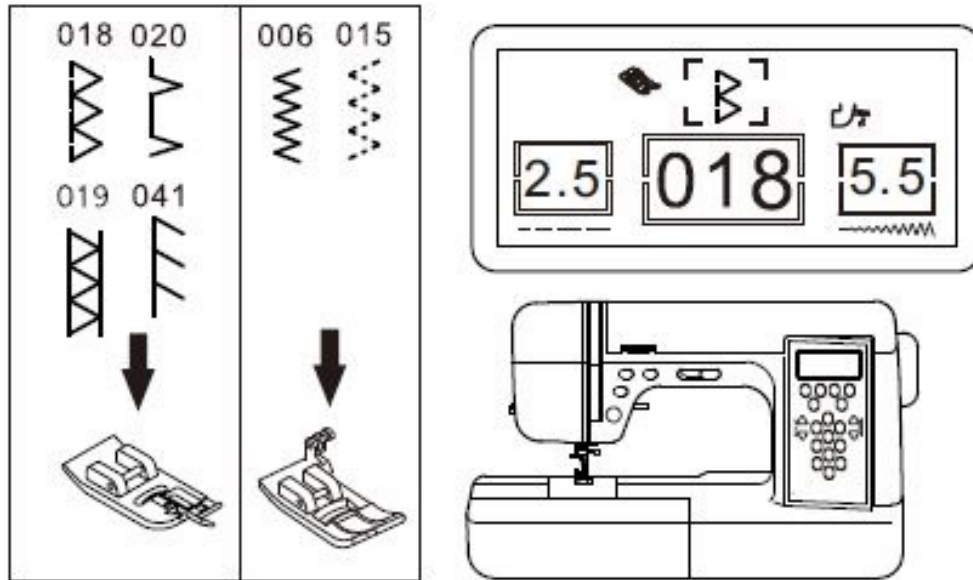

Blind seam stitch:

This stitch is used for sewing a blind seam (for example in a woolen coat or in curtains).

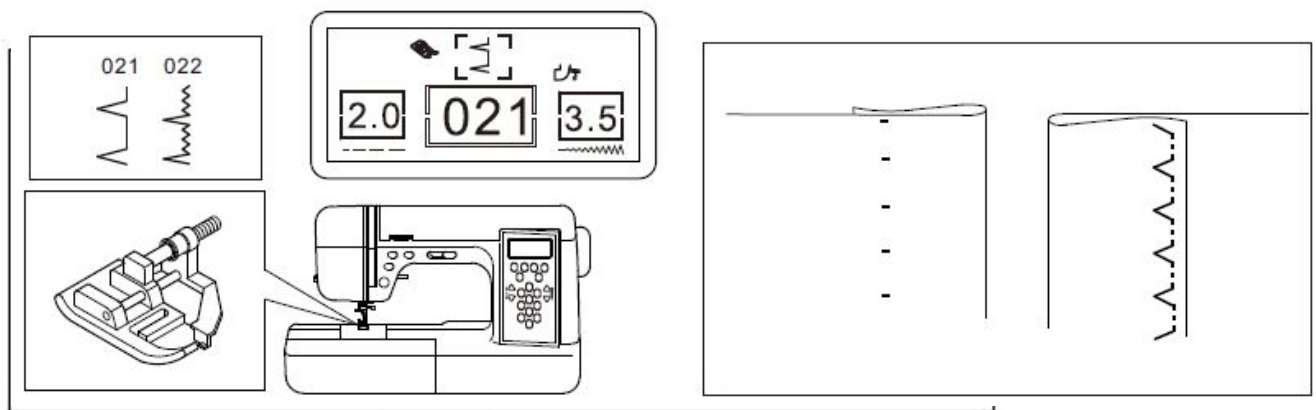

For the blind seam you can choose two different approach:

- Finish the raw edge with a zigzag stitch before the blind hem
- fold over the raw edge for about 1 cm and sew it the with the blind seam at the same time .

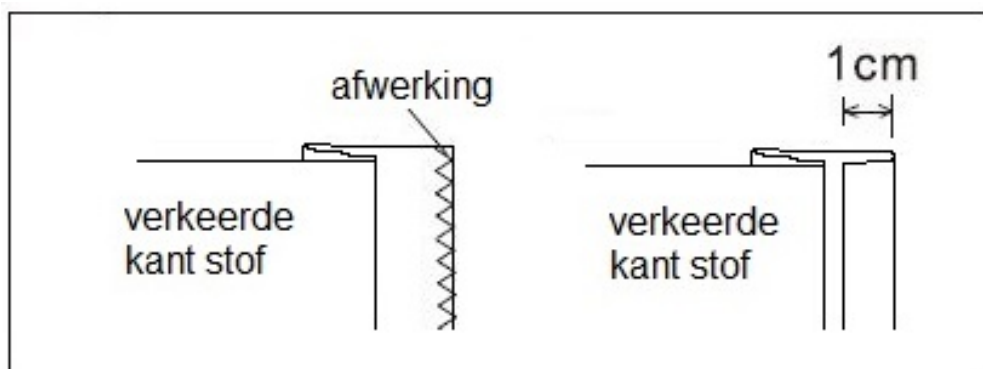

- Verkeerde kant stof = wrong side of fabric
- Afwerking = finish of fabric edge

With screw B you can adjust plastic guide (A). While sewing the straight stitch part the needle needs to fall exactly in the fabric as shown by the arrow.

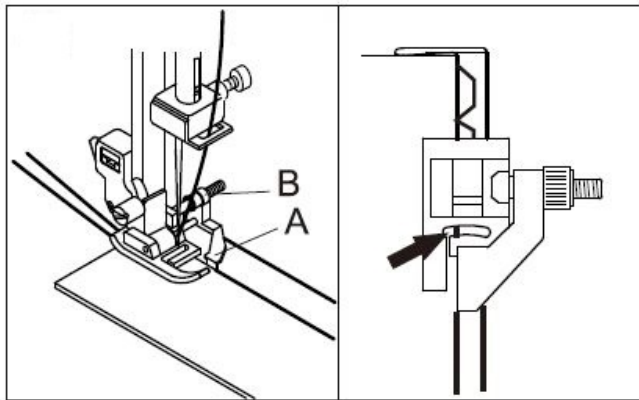

After sewing the blind seam, the seam is almost invisible on the right side of the fabric (just a few dots of thread). For that, unfold the fabric after sewing.

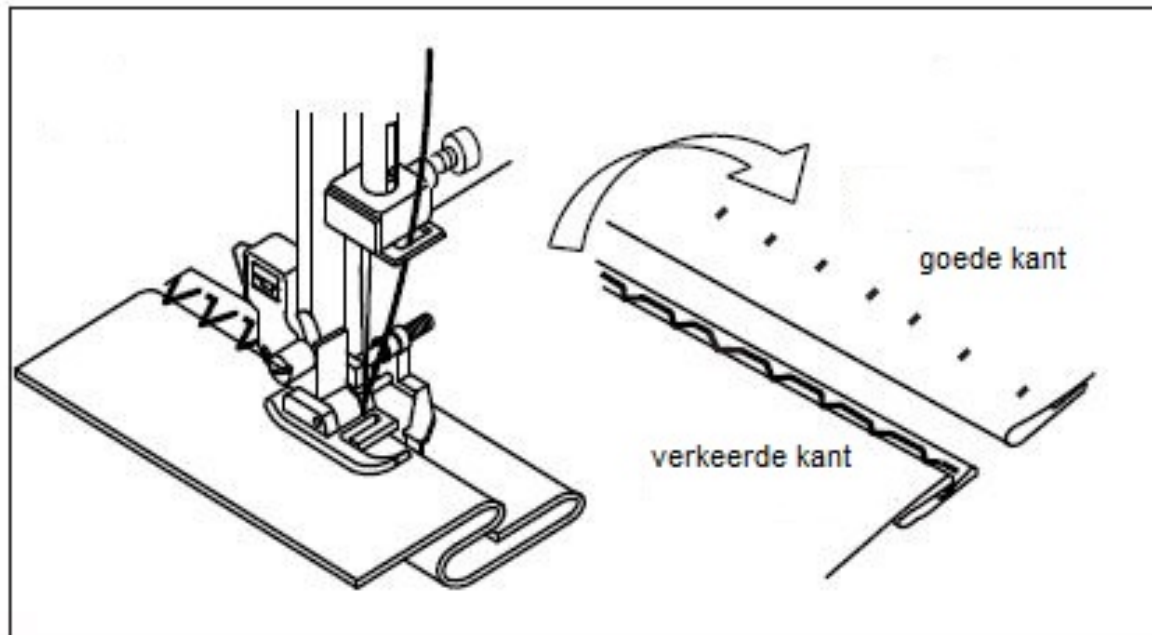

Buttonholes:

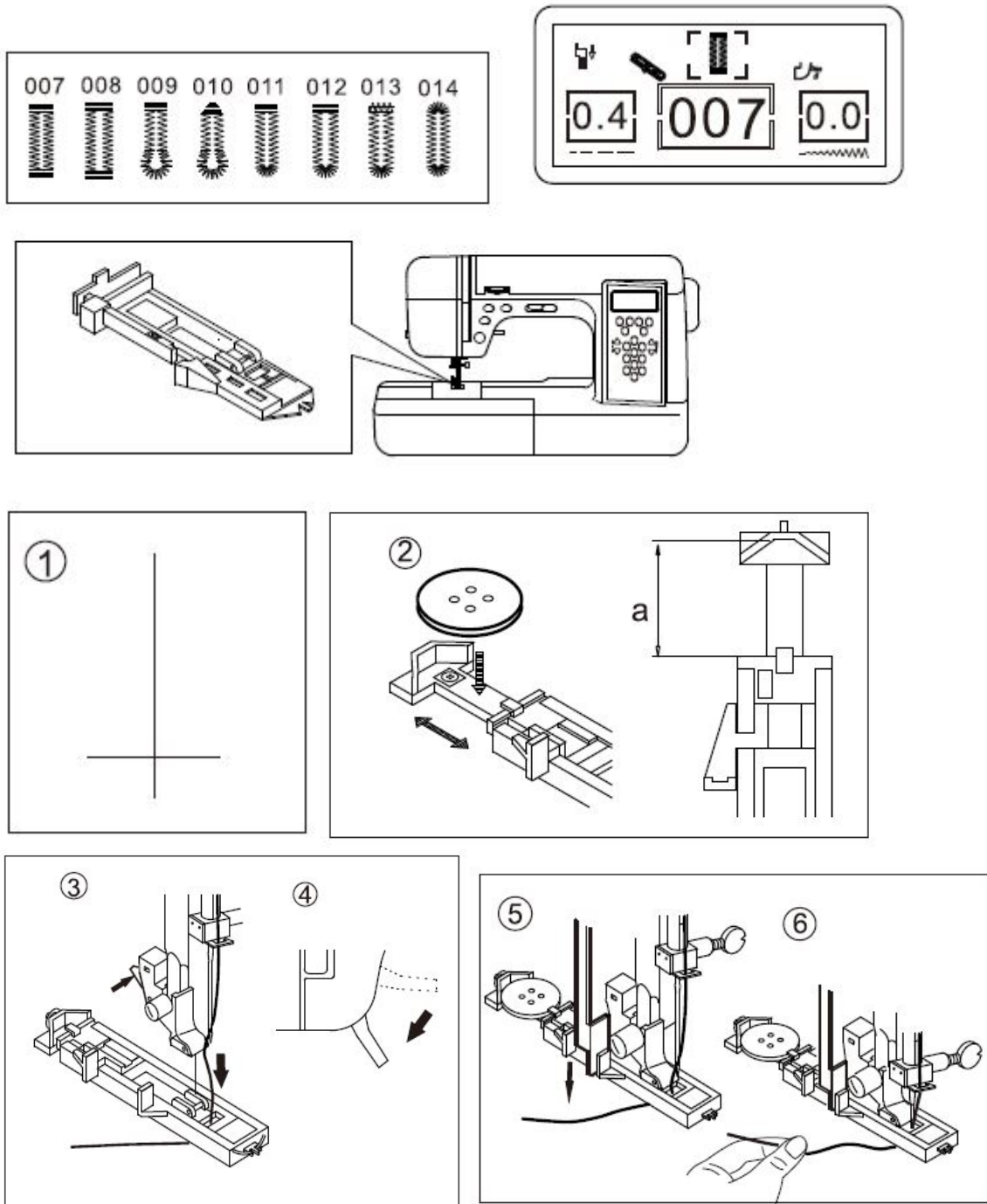

The order in which the buttonholes is sewn, is explained in the manual.

Always test a buttonhole on a piece of fabric (as used in your project).

Stitched zigzag stitch:

This stitch is used to sew on elastic band (A), or to finish fabric edges (B).

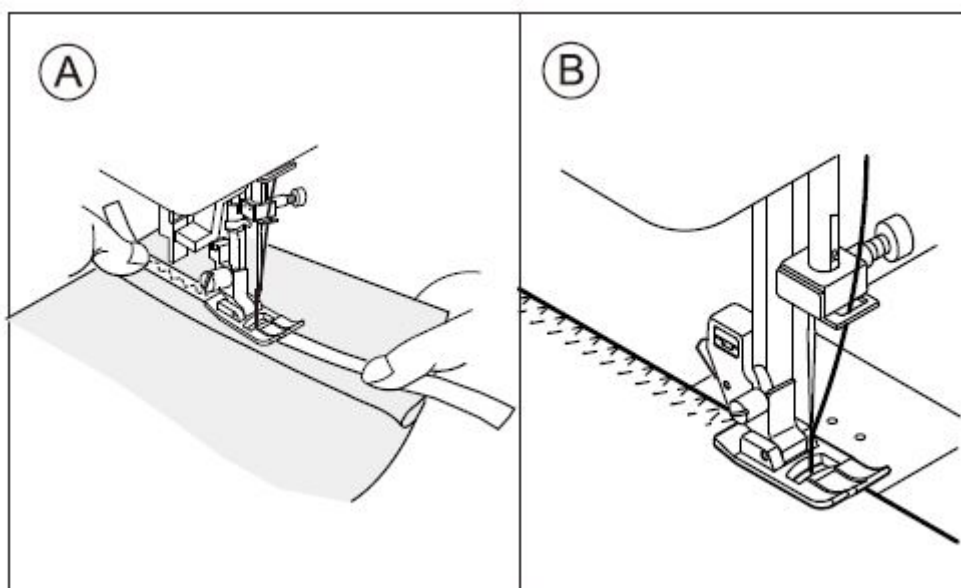
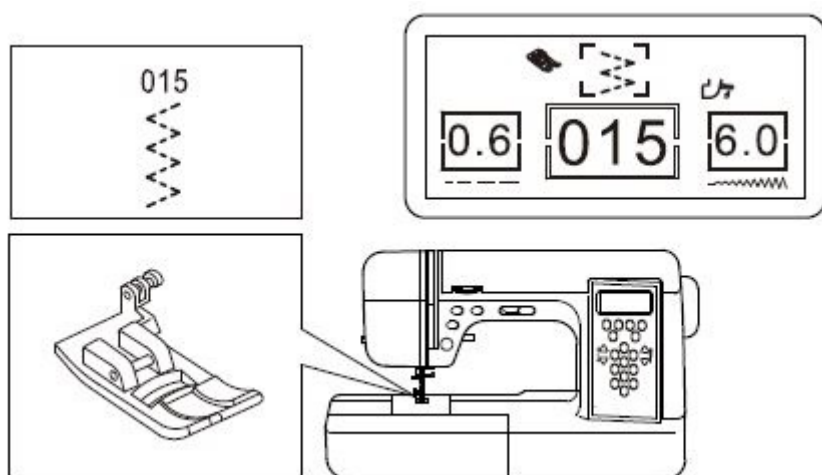

Stretch straight stitches (004, 005) and stretch zigzag (017) stitches:

For sewing stretch fabrics, always test on a piece of fabric.

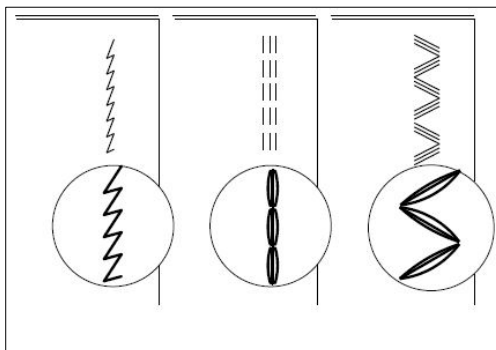
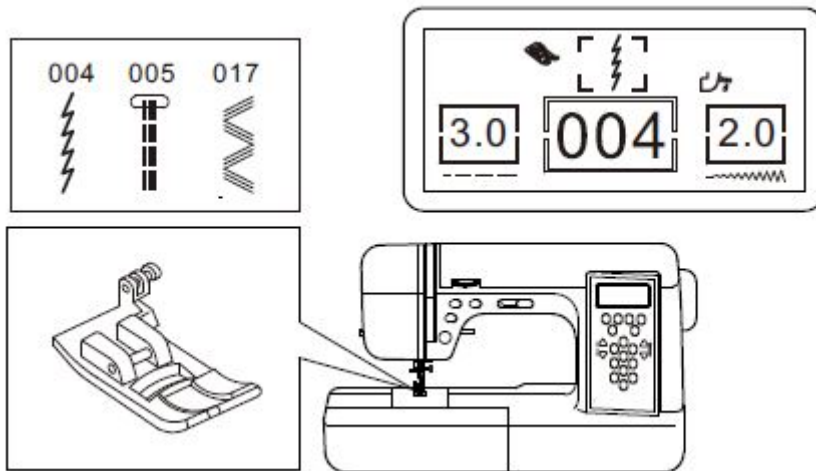

Patchwork stitches:

These are decorative stitches. For the best result, sew a seam with a straight stitch first (zie 1.). Press open the seam (zie 2.) and sew a decorative stitch on top (zie 3.).

onder andere:

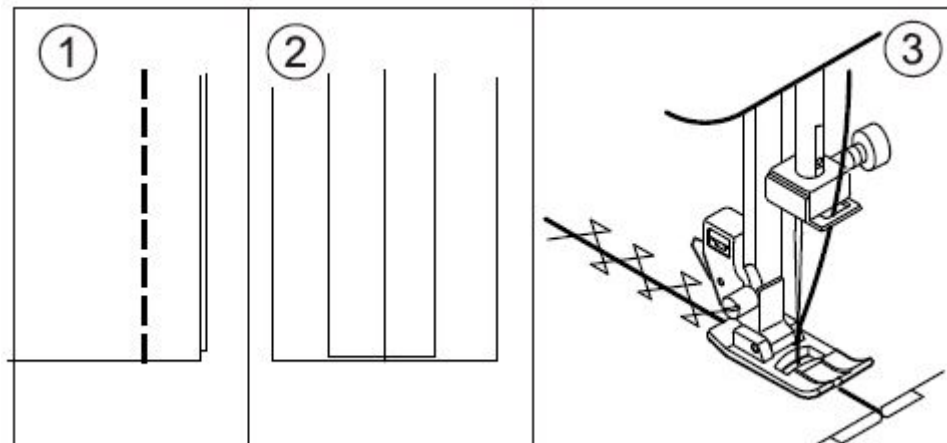
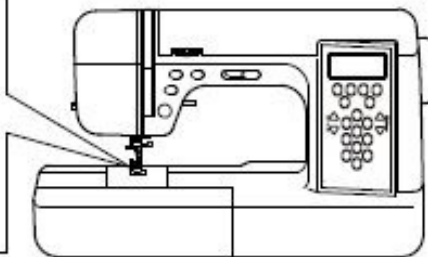
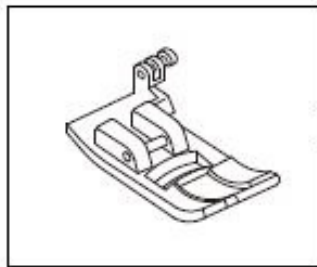
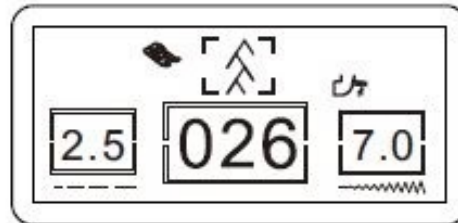
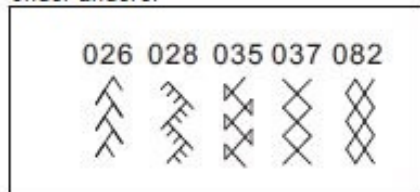

Appliqué stitch:

Baste the appliqué on top of the fabric, or use a iron with Vliesofix.

Use an appliqué stitch (038 to 042) to sew the appliqué.

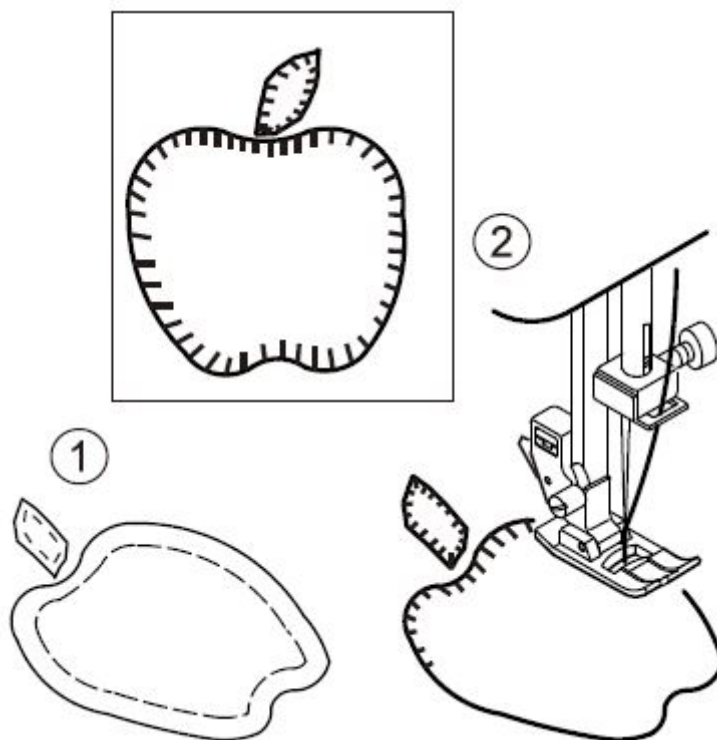
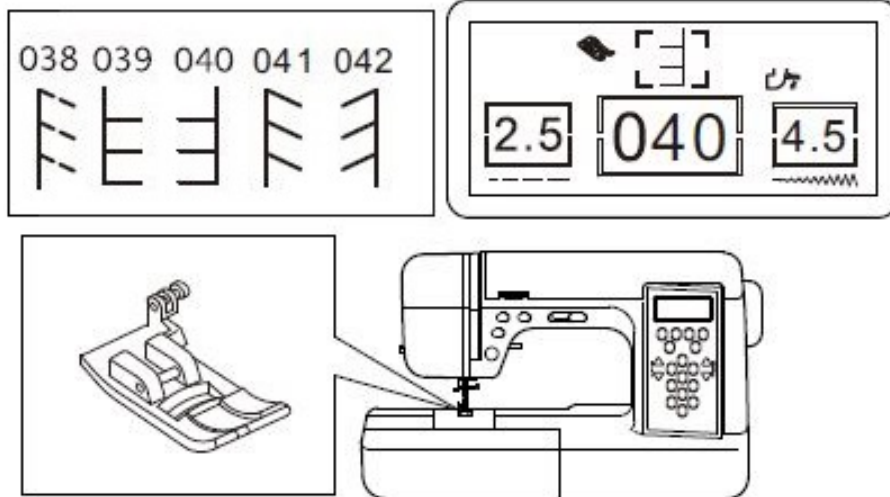

Zipper

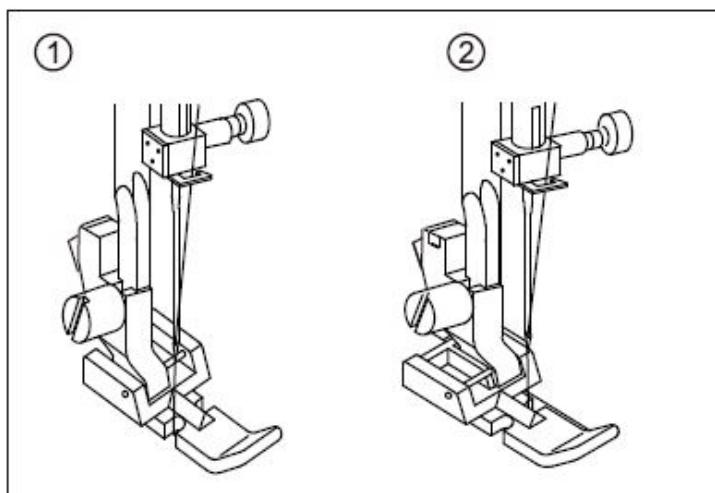
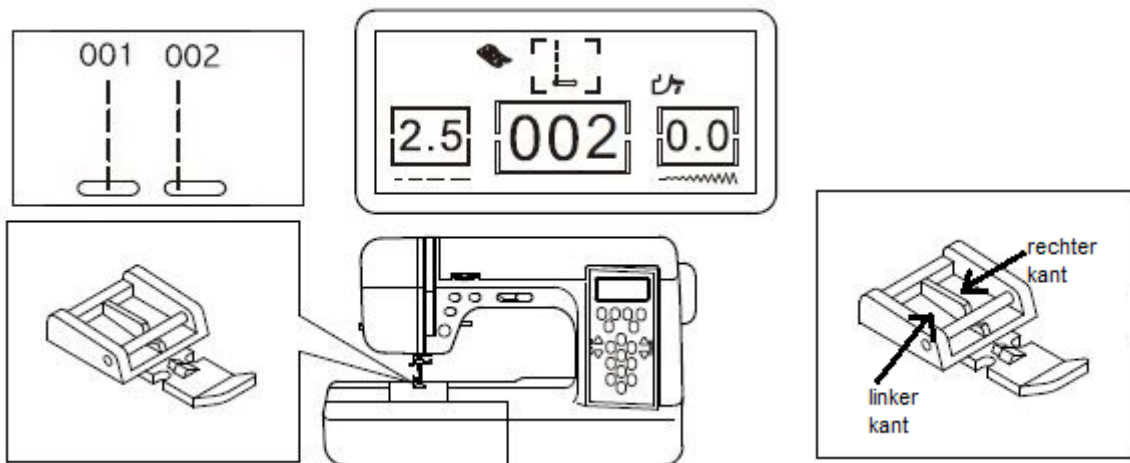

When using the zipper foot, you can use the left or the right side of the foot (1 and 2). Choose the right stitch according the side of the zipper foot.

When using the left side, you can choose stitch 001 or 002.

When using the right side, only use stitch 001, if not, the needle will hit the foot.

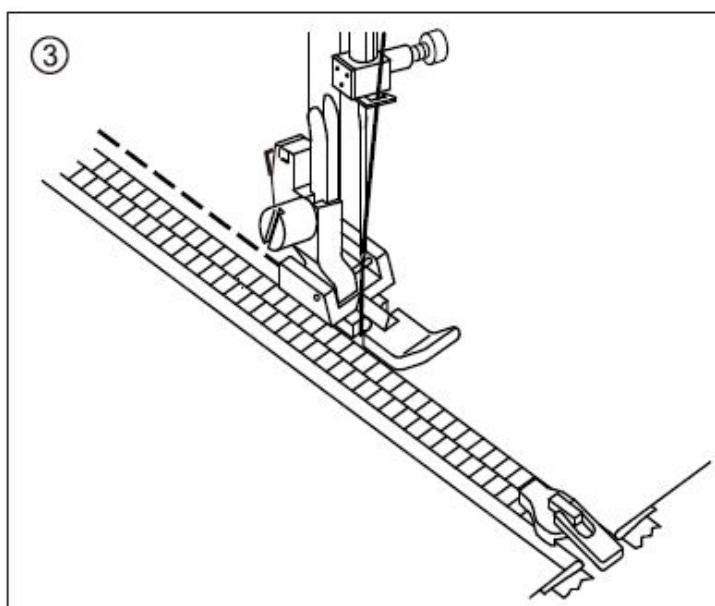

Piping with zipperfoot:

With the zipper foot you can sew very close near a folded over strip of fabric containing a cord. You can use this piping to trim edges of fabric.

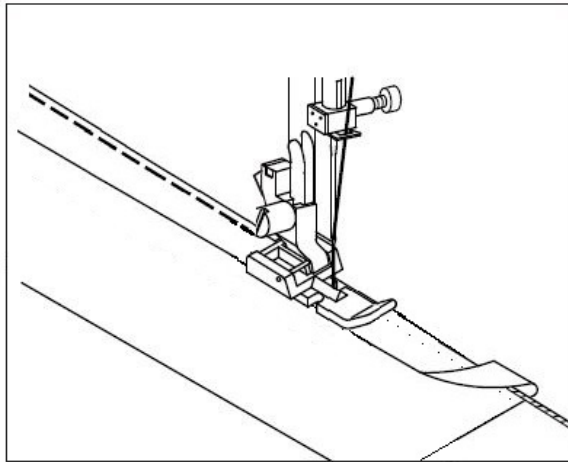

Wave stitch:

This is a decorative stitch, after sewing you can cut very near the stitch so you end up with a wavy edge.

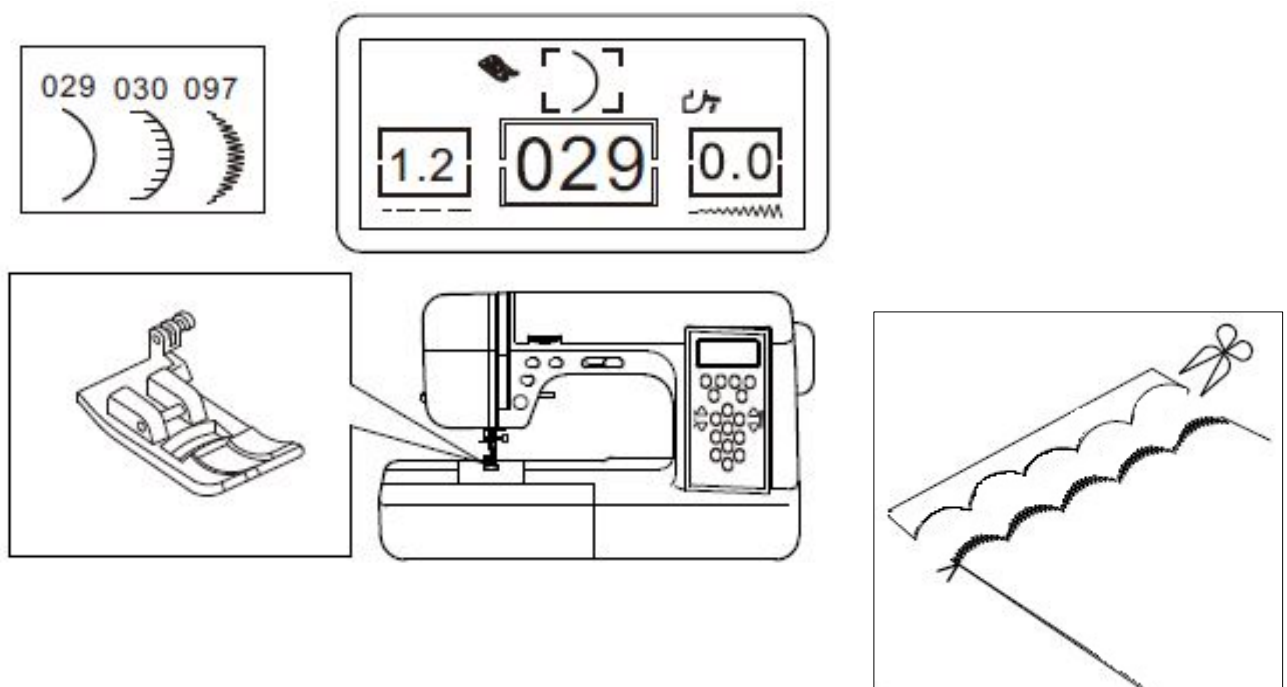

Free Hand Embroidery

For the best result use the embroidery foot (option) and use straight stitch 001. This comes in place of the standard foot support.

Move the fabric under the needle, up and down, left to right, in circles.....For making this easier, you can put the fabric in an embroidery hoop.

Free embroidery takes a bit of practice!

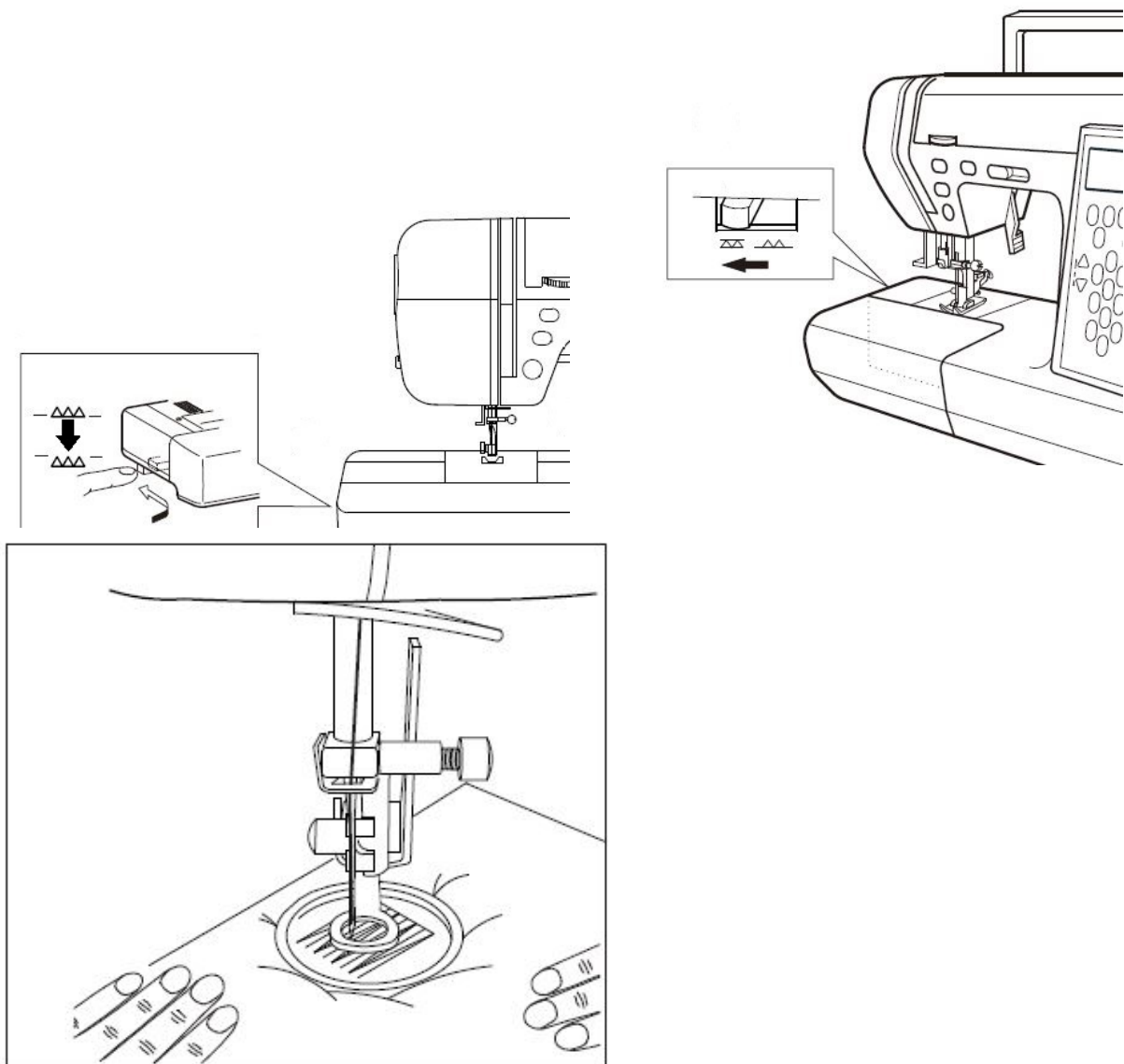

Good luck.

Copyright: www.matri.nl